

IT WALL EASEMENT
REFER TO TITLE PLAN

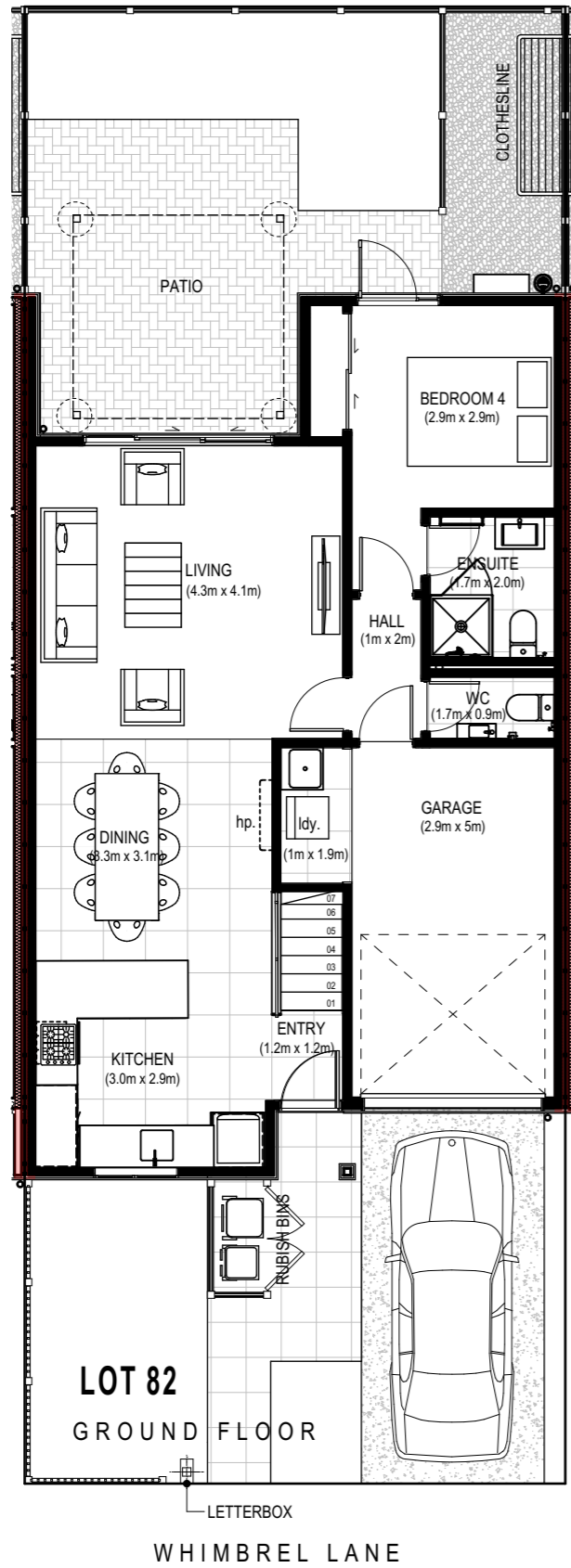

LOT 82 - TYPE H1

Whimbrel Lane,
Ormiston Town Centre,
AUCKLAND

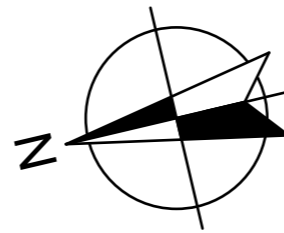

SITE AREA = 161.7 m²
TOTAL GROSS FLOOR AREA = 164.2 m²

Ground Floor = 85.4 m²
First Floor = 78.8 m²

FLOOR PLAN

